

## Key Features:

- No unsightly weep holes needed
- Improves aesthetics of building
- 30 minutes fire rating
- For cavities up to 50mm
- Compact 6.3lm roll
- Simply stapled into position



**TENMAT's** Cavity Fire Barrier on a Roll is a low profile intumescent which provides material and labour cost savings compared to the traditional method of using Cavity Trays, Cavity Socks & Weep Holes.

**TENMAT's** Cavity Fire Barrier on a Roll is designed for Timber and Masonry cavities. The product maintains the ventilated cavity to prevent thermal and moisture bridging and resultant damp problems, but in the event of a fire it expands to fill the cavity and prevent the spread of fire and smoke.

## Product Dimensions

4 mm x 75 mm x 6.3 m roll

## Traditional Method

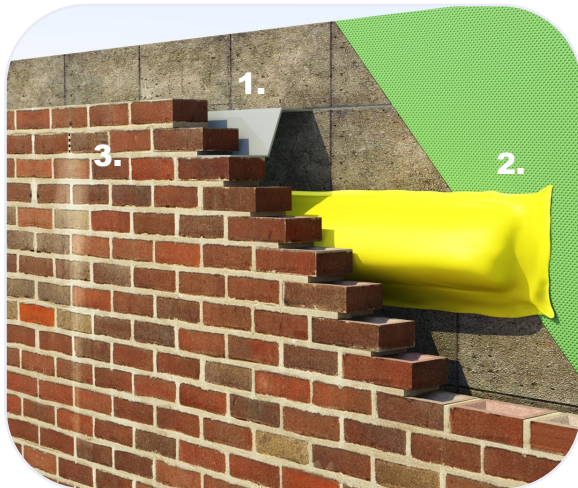

### 1. Cavity Trays

- Cavity is bridged = thermal & moisture bridging
- Can cause damp problems

### 2. Cavity Socks

- Creates unwanted sealed compartments
- Can often push brickwork away
- Susceptible to misalignment

### 3. Weep Holes

- Unsightly
- Discolouration of wall below
- Only allows limited air movement
- Risk of blockage
- Wind driven water issues

## TENMAT Method

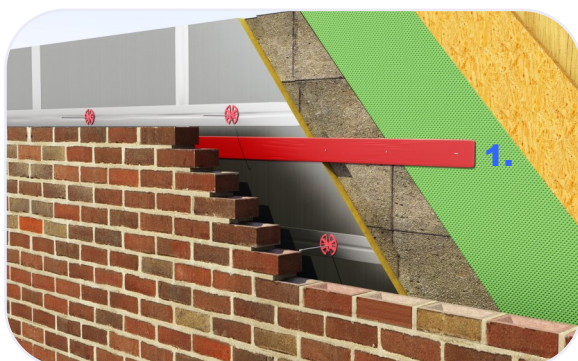

### 1. **TENMAT** Cavity Barrier on a Roll

- No Weep Holes needed = clean wall finish & no wind driven water issues
- No Cavity Trays needed
- Material & labour cost savings
- Product is 4mm thick and therefore maintains air gap
- Expands to fill cavity in event of fire
- Takes up imperfections and misalignments
- Restricts fire & smoke spread

## Fitting Instructions

Particularly suited for Timber Frame Construction, **TENMAT**'s Cavity Fire Barrier on a Roll is supplied in 6.3 metre lengths improving installation time and reducing storage requirements over traditional cavity socks.

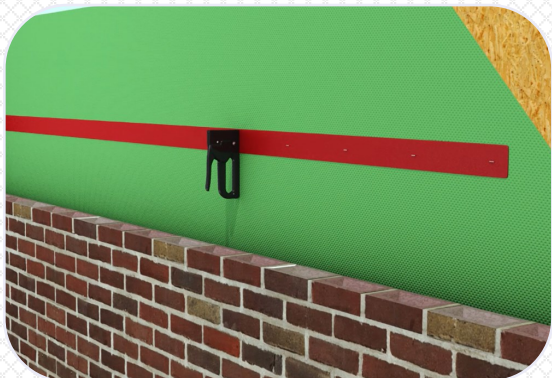

- Staple Cavity Fire Barrier on a Roll along centre line using 14mm long corrosion resistant staples at 250mm centres
- All joints should be tightly butted together so that the intumescent material is continuous throughout the cavity

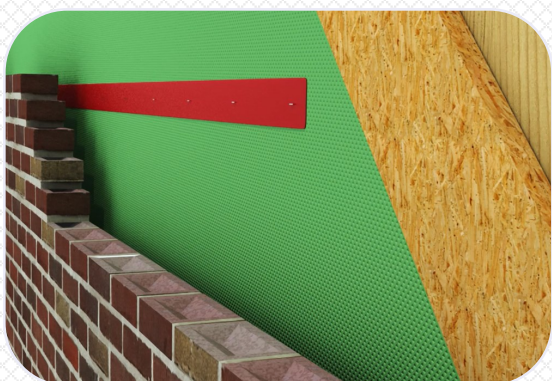

- The **TENMAT** Cavity Fire Barrier should be installed in such a way to ensure the cavity is left open to allow it to expand freely in a fire situation



- In a fire situation, the Cavity Fire Barrier on a Roll will expand across the cavity to restrict the spread of fire & smoke in the cavity

If the **TENMAT** Cavity Fire Barrier on a Roll is cut, then the polythene sleeve should be folded around the exposed end to maintain weather protection. This should then be stapled to the sheathing board.

**Cavity Fire Barrier on a Roll fixed to Timber Construction with Brickwork**

